

# Contour Projector

FINE ART ILLUMINATION



ETL LISTED, CONFORMS TO UL STD. 1598, CERTIFIED TO CAN/CSA STD C22.2 NO. 250.0  
U.S. PATENT #6,832,845



## ORDERING INFORMATION

### ORDERING EXAMPLE:

TOP ACCESS HOUSING INCLUDING 75 WATT OPTICAL PROJECTOR, METAL TEMPLATE, 120V ELECTRONIC TRANSFORMER, 75FL LENSES & UNFINISHED HEAT SHEILD

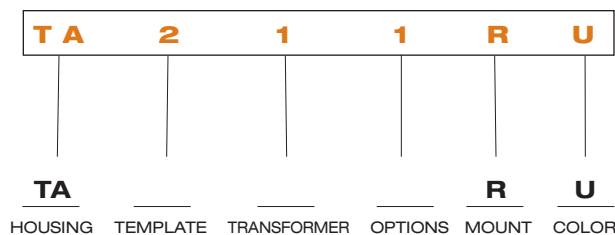

# TA SERIES

## TOP ACCESS HOUSING

### CONTOUR PROJECTOR

### DESCRIPTION

This housing is perfect for custom applications that require a smooth ceiling appearance. This model is used when access from below is not practical or you want to minimize the ceiling penetration by performing a custom template installation similar to the Wendel technique. Phantom Contour Projectors are designed by a professional installer and have been engineered so a novice, do it yourselfer or qualified electrician can successfully illuminate art. The patented mounting method, simplified optical system and the ability to use both shutters and custom templates make this one of the most versatile and awesome art lighting fixtures on the market today. By shaping the light to only the canvas, the art takes on a "Lighted from within" look that can only be seen to appreciate.

### SPECIFICATIONS/FEATURES

**PROJECTOR:** Constructed of .25 (SCH40) aluminum with two 60mm condensing lenses and two more 39mm, 75fl focal lenses standard (150fl focal lenses, engineered for longer, narrower throws, are available as a special order option.) See photometric chart on back of cut sheet or projector supplement for more information regarding lens selection.

**LAMP:** MR16 75-watt, 12-volt dichroic halogen lamp, 2-pin GU5.3 base with average lamp life of 3500 hours and color temperature of 3000K. Lamp Code: JCR12V-75W/FO

**HOUSING:** Constructed of .06 (#5052) aluminum, this sturdy housing is low profile and designed to accommodate the most demanding application.

**ROTATING RING:** Constructed of .08 (#5052) aluminum, this rotating ring is flexible and designed for a full 360 degree rotation with four positive locking knobs to secure the projector into position.

**MOUNTING CRADLE:** Constructed of .08 (#5052) aluminum, this universal cradle has three anchoring slots and multiple pivoting positions for both vertical and horizontal applications up to 55 degrees.

**MOUNTING BRACKETS:** Constructed of 1/8" cold rolled steel, these heavy-duty bars are designed to accommodate up to 24" joist spacing. Commercial brackets are available by special order.

**ELECTRICAL:** The Junction box is designed with a quick connect/disconnect for easy installation or removal of the projector and houses an electronic 120/12V step down power supply. Magnetic transformers and 277V options are available upon request. The junction box is listed for branch circuit wiring and comes equipped with a thermal protector that provides protection against over lamping and improper installation of ceiling insulation. Thermal Protector meets NEC and UL requirements.

**HEAT SHIELD:** Constructed of .05 (#5052) aluminum this protective disk has two easy to remove perforated knockouts to accommodate both vertical and horizontal installations.

### TEMPLATE

ORDER CODE #	DESCRIPTION
2	Metal Slide
3	Metal Gobo
4	Glass Gobo

### TRANSFORMER

ORDER CODE #	DESCRIPTION
1	Electronic 120V
2	Electronic 277V
3	Magnetic 120V
4	Magnetic 277V

### OPTIONS

ORDER CODE #	DESCRIPTION
1	None
2	UV Filter
3	150fl Lenses
4	Pin Hole Cover

### MOUNT

ORDER CODE #	DESCRIPTION
R	Recessed

### COLOR

ORDER CODE #	DESCRIPTION
U	Unfinished



607 Durham Drive | Houston, Texas 77007-5316  
Tel: 713.863.1133 | Fax: 713.863.0044 | 800.863.1184  
[www.phantomlighting.com](http://www.phantomlighting.com)

© Copyright 2008 Phantom Lighting Systems

## DETERMINE LOCATION OF PROJECTOR IN CEILING

### VERTICAL AIMING AT 45° ANGLE

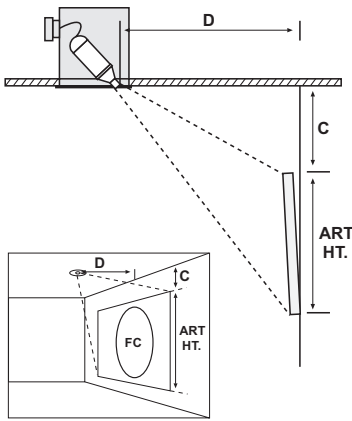

### FORMULA (Standard 75f Lenses)

#### Painting Size (60"H x 50"W @ 32" from ceiling)

C = Distance from ceiling to top of art  
D = Distance from wall

$$C + 1/3 \text{ of art height} + 4 = D$$

(Example: 32" + 20" + 4" = 56" or 6' back from wall)  
Your circle of light on the wall will be **63"**  
Approximately **43** foot candles of light\*

\*See grey shaded area in photometrics chart

### HORIZONTAL BEAM

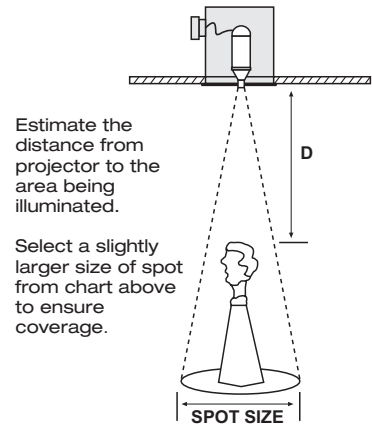

Estimate the distance from projector to the area being illuminated.

Select a slightly larger size of spot from chart above to ensure coverage.

## PHOTOMETRICS

### STANDARD 75 FOCAL LENGTH LENSES DISTANCE TO OBJECT

BEAM SPREAD	2'		3'		4'		6'		8'		10'	
	SPOT SIZE (IN.)	FC	SPOT SIZE (IN.)	FC	SPOT SIZE (IN.)	FC	SPOT SIZE (IN.)	FC	SPOT SIZE (IN.)	FC	SPOT SIZE (IN.)	FC
43°	20	456	30	186	42	99	63	43	75	24	107	14
58°	26	269	44	121	53	70	71	33	106	18	120	12
67°	31	206	47	96	62	55	102	25	128	14	156	9
77°	47	117	70	52	91	30	120	14	154	8	190	5

### OPTIONAL 150 FOCAL LENGTH LENSES DISTANCE TO OBJECT

BEAM SPREAD	2'		3'		4'		6'		8'		10'	
	SPOT SIZE (IN.)	FC	SPOT SIZE (IN.)	FC	SPOT SIZE (IN.)	FC	SPOT SIZE (IN.)	FC	SPOT SIZE (IN.)	FC	SPOT SIZE (IN.)	FC
31°	11	1850	18	840	27	200	38	150	53	75	67	42
32°	12	1300	19	450	30	150	39	120	55	55	70	34
35°	13	1100	22	420	32	135	43	100	61	50	79	31
36°	14	1000	23	384	33	129	46	91	63	49	81	30

## HOUSING AND PROJECTOR DIMENSIONS

### HOUSING DIMENSIONS

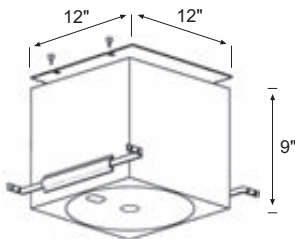

### TOP VIEW

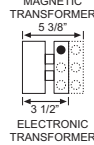
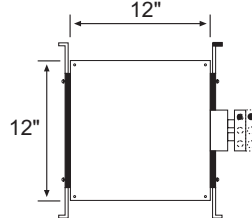

### PROJECTOR DIMENSIONS

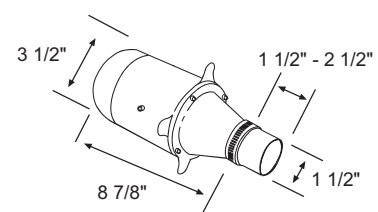

## TEMPLATE METHODS

### ADJUSTABLE SHUTTERS

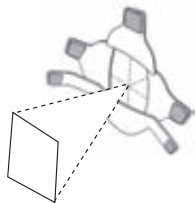

Each Phantom Projector comes with 3 different shutter assemblies that are specially designed to compliment a particular beam configuration by adjusting the light to follow the curvature of the lens. This allows for clean, straight lines, regardless of the aiming angle.

### METAL SLIDE

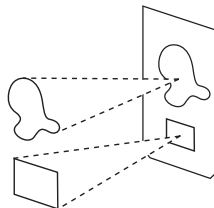

A Metal Slide is used on custom cut templates that contour the light to multiple or irregular objects such as sculptures. To illuminate multiple objects on the same wall they must be installed in a collage format.

### METAL GOBO



A Metal Gobo is used for projecting black and white images or patterns to create a theatrical effect such as clouds, leaves or structural shapes. Manufactured like a stencil, all elements of the metal gobo design must be connected with tabs to the outer ring of the gobo. Over 700 patterns are available.

### GLASS GOBO



A Glass Gobo is used for projecting color images, patterns or logos to create a refined and professional look. Silk Screened Glass Gobos are made on quartz glass using a unique coating silk screened onto the base from digital files. This "painted" coating allows your design to avoid "tabbing" needed in custom steel gobos.



607 Durham Drive | Houston, Texas 77007-5316  
Tel: 713.863.1133 | Fax: 713.863.0044 | 800.863.1184  
[www.phantomlighting.com](http://www.phantomlighting.com)  
© Copyright 2008 Phantom Lighting Systems