



# AC Series

Adjustable Shelf Lighting  
(For New Construction)



**Phantom™ Elite AC Series LED** light strips are designed for fully adjustable shelf and cabinet linear lighting applications and represent a breakthrough in strip lighting technology. Just imagine having the ability to freely move your lighted shelves without the need for tools or rewiring! These low profile cabinet lights are easily concealed regardless of the shelf design, giving new definition to the phrase, “See the Light, Not the Fixture.” Custom mounting trims establish the optimum aiming angle which allows the contents of any cabinet to be illuminated to a precise degree at the highest level of aesthetics yet to be seen. Phantom Elite Strips are constructed using the highest quality LED’s in the industry and produce 3.5 watts per foot of linear illumination at 80 CRI. They are among the brightest LED tape lights on the market, emitting 130 lumens per foot for coated and up to 180 lumens per foot for uncoated. Strips are precut to any desired length to be custom fitted to movable shelves. There are no visible wires and shelf positions can be changed without any rewiring whatsoever. Strips are dimmable using a standard low voltage dimmer and produce a quality of consistent color unmatched by competing products. For higher lumen output applications up to 4.7 watts or 400 lumens per foot, we invite to investigate our **Phantom Ultra Series**.

### The Phantom Elite AC Series Features

- Low profile, linear light source designed for new construction adjustable shelf lighting applications
- Exclusive current carrying design using concealed metal buss bars and mounting hardware
- Multiple metal mounting trims designed for total light control, flexibility and concealment
- High performance, compact magnetic low voltage 24VDC drivers
- Full range dimming down to 4% when used with a magnetic low voltage dimmer control
- 2300K, 2700K, 3000K, 3500K and 4000K color temperatures available
- Red, Green, Blue, Amber and Pink monochromatic colors available
- 12” modular tape design between connectors with cut marks every 4”
- ETL Approved, Conforms to UL STD 1598, Conforms to CSA C22.2, NO.250.0

### Phantom Elite Lighting Strips - Ordering Matrix

Sample Order Number: **AC-E-C-1-27-3-AD-12-FW-24**



Model	Series	Coating	Trim Profile	Color Temp	Watts / Ft	Leads Wire*	Lead Length	Color	Trim Length
<b>AC</b>	<b>E</b>	<b>C</b>	<b>1</b>	<b>27</b>	<b>3</b>	<b>AD</b>	<b>12"</b>	<b>FW</b>	<b>24"</b>
<b>AC</b>	<b>E - Elite</b>	<b>C - Coated</b> <b>U - Uncoated</b>	<b>1</b> <b>2</b> <b>3</b> <b>4</b>	<b>23 - 2300K</b> <b>27 - 2700K</b> <b>30 - 3000K</b> <b>35 - 3500K</b>	<b>3 - 3.5W</b>	<b>AD - Adjustable</b>  *Facing Application	<b>12"</b>	<b>FW - Flat White</b> <b>GW - Gloss White</b> <b>FB - Flat Black</b> <b>GB - Gloss Black</b> <b>LB - Light Beige</b> <b>MB - Medium Brown</b> <b>LA - Light Almond</b> <b>UF - Unfinished</b> <b>CC - Custom Color</b>	<b>Inches</b>
				<b>R - Red</b> <b>G - Green</b> <b>B - Blue</b> <b>A - Amber</b> <b>P - Pink</b>					

EASY-TO-USE, DOWNLOADABLE ORDER FORMS WITH ACTIVE FORM FIELDS AT [PHANTOMLIGHTING.COM](http://PHANTOMLIGHTING.COM)



## AC Elite Series Trim Profiles

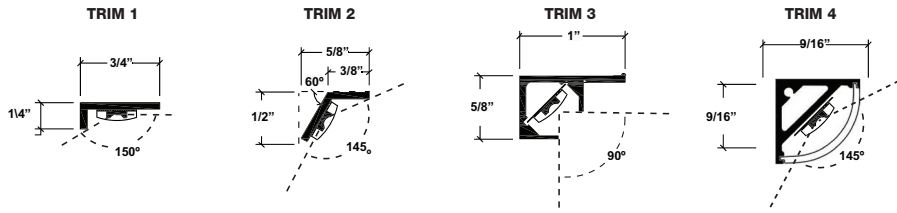

## AC Elite Series LED Strip

The Phantom LED Strip Light is a low profile integral tape with diode spacing 0.67 inches on centers, operating at 24VDC and 3.5 watts per foot. Available Color temperatures are 2300K (candlelight), 2700K (warm like household lighting), 3000K (Slightly cooler like Halogen), and 4000K (cool white). The 2700K tone coordinates well with most residential lighting, while the 3000K tone makes colors appear more vivid for display purposes. The crisp whiter tone of 4000K is often preferred for commercial displays of diamonds and crystal. Life expectancy of the diodes is rated at 50,000 hours. Unlike ordinary light bulbs, these strip lights are virtually heat-free. Dimming is accomplished with an ordinary low voltage dimmer, rather than specialized dimming driver.

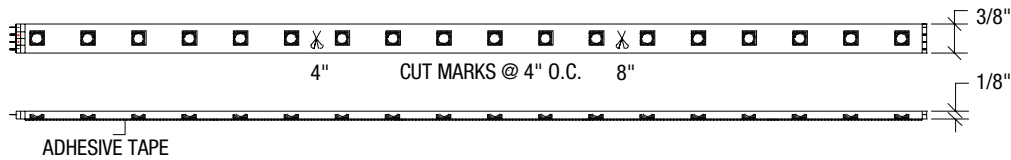

## AC Elite Series Exploded View

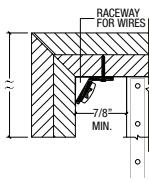

**Space Requirement**  
For best results, a wood reveal should be used to conceal the fixture. For applications above eye level use and extend wood trim as necessary. Allow 1" clearance between light fixture and holes.

### Lighting Strip

Each lighting strip contains leds spaced at 0.67 inch on center. For best results, always use a matte finish on the back of the cabinet to minimize reflections or glare.

### Bus Bar Supports (5/8" W X 1/4" D)

Heavy duty steel buss bars are concealed during construction and engineered to perfectly align with 8 x 32 threaded holes drilled 32 mm on center. This system totally hides all the wiring and allows you to use the drilled pin method of shelf support. Consult the factory for other spacing options.

### Drivers

Magnetic drivers are sized to match the total wattage of your lighting load and come equipped with one or more secondary circuit breakers. (See driver sheet for more sizing information and amperage calculations).

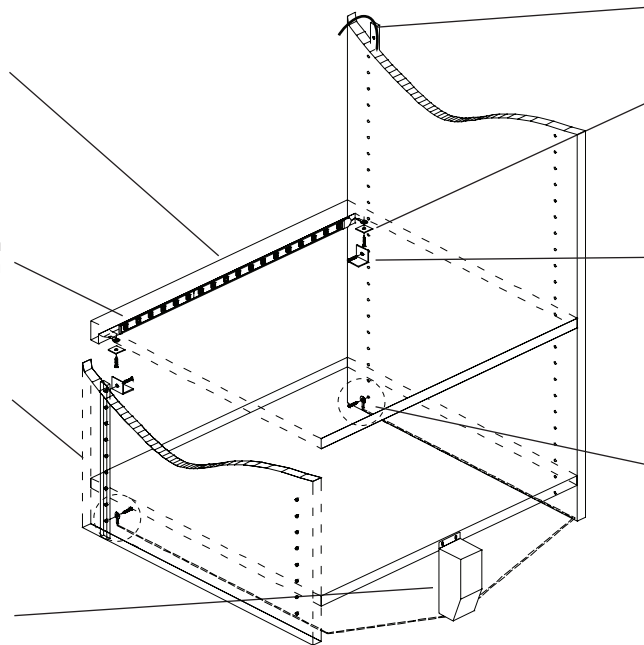

### Top Header Lead Wires (Pair)

Always use the header kit to avoid exposed wires.

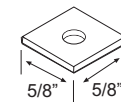

### Brass Contact Pads

Brass contact pads are designed to transfer electricity from the shelf support clip to the individual fixtures utilizing a safe low voltage current.

Contact is made when the shelf is installed. No tools are required to rearrange the shelves!

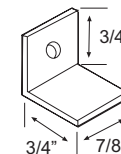

### Brass Support Clips

Brass support clips are designed to transfer electricity from the concealed buss bar to the brass contact pad mounted on the bottom of the shelves utilizing a safe low voltage current. Standard right angle pins

should be used to support the back of each shelf and are not included in the kit.

### Lug Connectors

Heavy duty lug connectors are used to connect the wire to the metal buss bars back to the power supply. These connections must remain accessible for service and maintenance.

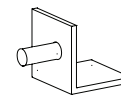

### Back Clip Shelf Support (by others)

## AC Elite Series Drivers

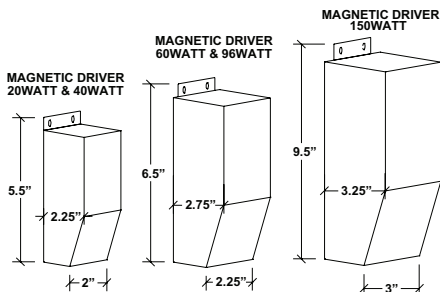

### Driver Specifications

Specifications	20 VA	40 VA	60 VA	96 VA	150 VA	192 VA	288 VA
Maximum Wattage	16	32	48	76	150	96 x 2	96 x 3
Height (H)	5.5"	5.5"	6.5"	6.5"	9.5"	9.8	9.8
Width (W)	2.25"	2.25"	2.75"	2.75"	3.25"	3.25	4.25
Depth (D)	2"	2"	2.25"	2.25"	3"	3	3.5
24 Volt (CB)	(1) Auto	(1) Auto	(1) Auto	(1) Auto	(1) Auto	(2) Auto	(2) Auto
Weight (lbs.)	1.8	1.8	2.0	2.0	5.0	5.5	8.75
Part #'s	MD20	MD40	MD60	MD96	MD150	MD192	MD288

To figure total requirements for transformers, calculate total watts per foot divided by voltage equals total amperage. (watts / voltage = amperage) Refer to the table to calculate wire size and fusing requirements or see driver page for more specific details.